



## CHANNEL NUT

With Top Spring  
Model NUTTS

**SIZE:**

1/4", 3/8" & 1/2"

**FINISH:**

Electro-zinc plated

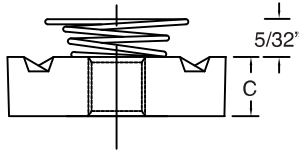
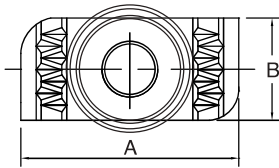

**Channel Nut: Weights (LBS) • Dimensions (IN)**

ITEM CODE	THREAD SIZE	WEIGHT	A	B	C
NUTTS-0025EG	1/4 - 20	0.07	1 3/8	3/4	1/4
NUTTS-0037EG	3/8 - 16	0.08	1 3/8	3/4	3/8
NUTTS-0050EG	1/2 - 13	0.09	1 3/8	3/4	1/2

FASTENER SIZE	1/4-20	5/16-18	3/8-16	1/2-13
Foot - lbs	6	11	19	50
Nm	(8)	(15)	(26)	(68)