

FORGED BRASS BALL VALVE

One Piece Body • Reduced Port
 G/F + PTFE Seats/Seals • Blowout Proof Stem
 Chrome Plated Ball • Stainless Steel Lever Handle

CODE # 51 (AKTK) THREADED

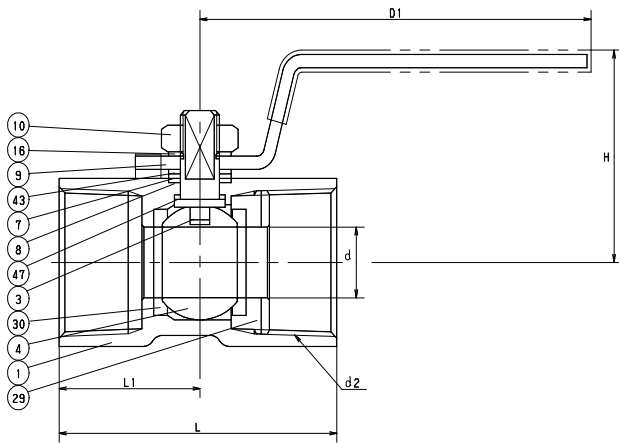

STANDARDS	
END TO END	KITZ
END CONNECTION	ANSI B1.20.1
WALL THICKNESS	KITZ

PRESSURE/TEMPERATURE	
150 PSI - SATURATED STEAM TO 366°F	
600 PSI - NON-SHOCK COLD WATER, OIL OR GAS	

NOTE: PRESSURE/TEMPERATURE CHART - PAGE BV-35

MATERIAL LIST		
NO.	NAME OF PART	SPECIFICATION
1	BODY	FORGED BRASS (B283, C37700)
3	STEM	SPECIAL BRASS (KITZ "K" METAL)
4	BALL	(1) FORGED BRASS (B283, C37700)
7	GLAND	STAINLESS STEEL (A276 TYPE 430)
8	GLAND PACKING	G/F PTFE
9	HANDLE	(2) STAINLESS STEEL (A276 TYPE 430)
10	HANDLE NUT	CARBON STEEL
16	SPRING WASHER	CARBON STEEL
29	INSERT	FORGED BRASS (B124, C37700)
30	BALL SEATS	G/F PTFE
43	SPRING	STAINLESS STEEL (A276 TYPE 304)
47	THRUST WASHER	REINFORCED PTFE

NOTES: (1) CR. PLATING
 (2) WITH PLASTIC COVERING

DIMENSIONS • WEIGHTS • QUANTITIES							
	d2 SIZE	d	H	D1	L	APPROX. NET WT.	CARTON QTY
in.	1/4	0.18	1.22	2.36	1.535	22	120
mm.		4.5	30.0	60.0	39.0	10.0	
in.	3/8	0.268	1.417	2.76	1.732	26	120
mm.		6.8	36.0	70.0	44.0	11.8	
in.	1/2	0.362	1.614	3.35	2.224	51	120
mm.		9.2	41.0	85.0	56.5	23.2	
in.	3/4	0.492	1.732	3.35	2.323	61	96
mm.		12.5	44.0	85.0	59.0	27.7	
in.	1	0.63	1.89	3.94	2.80	54	54
mm.		16.0	48.0	100.0	71.0	24.5	
in.	1 1/4	0.787	2.126	3.94	3.07	52	32
mm.		20.0	54.0	100.0	78.0	23.6	
in.	1 1/2	0.965	2.56	4.92	3.268	47	24
mm.		24.5	65.0	125.0	83.0	21.4	
in.	2	1.26	2.835	4.921	3.937	52	16
mm.		32.0	72.0	125.0	100.0	23.6	

SPECIFICATION

Approved valve shall have one piece forged brass body, blowout proof stem, G/F + PTFE seats/seals, chrome plated ball, stainless steel handle and reduced port design. Valves shall be pressure rated to 150 WSP/600 WOG.

KITZ Code No. 51 (AKTK) Threaded Ends