

# FORGED BRASS BALL VALVE

## MAINTENANCE FREE DOUBLE O-RING STEM SEALS

Two Piece Body • Full Port • Chrome Plated / Vented Ball  
 Blowout Proof Stem (Ni Plated) • PTFE Seats  
 NSF • CSA (US/C) • UL • FM\*\*

➔ **CODE # 58W (AKSZAW)**  
**THREADED**

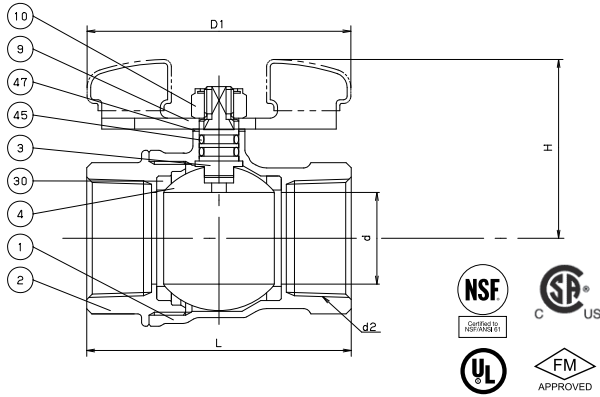

**CODE # 59W (CSZAW)**  
**SOLDER\***

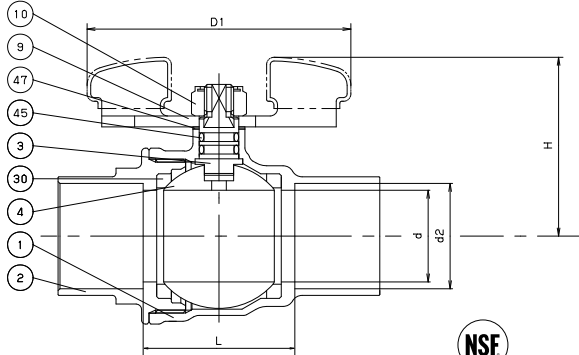

\*REFERENCE VALVE INSTALLATION TIPS FOR SOUND SOLDER JOINTS (PAGE BV-70) OR SEE INSTALLATION SHEET PACKAGED WITH VALVE.

### SPECIFICATION

Approved valve shall have two piece forged brass body, blowout proof stem (Ni Plated), PTFE seats, maintenance free double o-ring stem seals, chrome plated ball and full port design with wing handle. Valves shall be pressure rated to 150 WSP/600 WOG and conform to MSS-SP 110 and NSF, CSA, UL & FM.

KITZ Code No. 58W (AKSZAW) Threaded Ends  
 59W (CSZAW) Solder Ends

### STANDARDS

END TO END	KITZ
THREADED ENDS	ANSI B1.20.1
SOLDER JOINT ENDS	ANSI B16.18
WALL THICKNESS	KITZ
CONFORMS TO MSS-SP 110 - REPLACES US. FED. SPEC. WWW-V-35B, TYPE II, CLASS A, STYLE 3	

### PRESSURE/TEMPERATURE

150 PSI SATURATED STEAM TO 366°F  
 600 PSI - NON-SHOCK COLD WATER, OIL OR GAS

NOTE: PRESSURE/TEMPERATURE CHART - PAGE BV-35

### MATERIAL LIST

NO.	NAME OF PART	SPECIFICATION
1	BODY	FORGED BRASS (B283, C37700)
2	BODY CAP	FORGED BRASS (B283, C37700)
3	STEM	(1) BRASS ROD (B16)
4	BALL (Vented)	(2) FORGED BRASS (B283, C37700) STRAIGHT OR HOLLOW BALL
9	HANDLE	(3) CARBON STEEL
10	HANDLE NUT	CARBON STEEL
30	BALL SEATS	PTFE
45	O-RINGS	FPM
47	THRUST WASHER	PBT

NOTES: (1) Ni PLATING  
 (2) CR. PLATING  
 (3) ELECTROPLATED ZINC WITH PLASTIC COVERING

### DIMENSIONS • WEIGHTS • QUANTITIES

	d2 SIZE	d	H	D1	L	L1	d1		APPROX. NET WT.	CARTON QTY
							Max.	Min.		
in.	1/4	0.39	1.32	2.17	1.65	1.05	-	-	29	120
		9.9	33.5	55.1	41.9	26.7	-	-	13.2	
in.	3/8	0.39	1.32	2.17	1.65	1.11	.506	.502	29	120
		9.9	33.5	55.1	41.9	28.2	12.9	12.8	13.2	
in.	1/2	0.59	1.55	3.76	2.08	1.13	.631	.627	29	96
		14.0	39.4	95.5	52.8	28.7	16.0	15.9	13.2	
in.	3/4	0.79	1.7	3.15	2.36	1.37	.881	.877	45	60
		20.1	43.2	80.0	59.9	34.8	22.4	22.3	20.5	
in.	1	0.98	2.06	4.33	2.83	1.64	1.132	1.128	60	36
		24.9	52.3	52.324	71.9	41.7	28.8	28.7	27.3	
in.	1 1/4	1.26	2.27	4.33	3.31	2	1.382	1.378	68	24
		32.0	57.7	57.658	84.1	50.8	35.1	35.0	30.9	
in.	1 1/2	1.57	2.88	5.9	3.62	2.35	1.633	1.628	50	16
		39.9	73.2	149.9	91.9	59.7	41.5	41.4	22.7	
in.	2	1.97	3.17	5.9	4.33	2.83	2.133	2.128	71	16
		50.0	80.5	149.9	149.86	71.9	54.2	54.1	32.3	

### CERTIFICATIONS:

NSF/ANSI STANDARDS 61-8, C-HOT (180°F/82°C)  
 CSA (US/C) -40°C~65°C (-40°F~149°F)  
 CGA 9.1b-2001/ANSI 21.15b-2006 - .5 PSI  
 CGA CR 91-002 - 2 PSI  
 ASME B16.44 - 5 PSI  
 CAN/CGA 3.16-M88 - 125 PSI  
 ASME B16.33-2002 - 125 PSI  
 UL-258 - 175 WWP (Fire Trim Protection Valves)  
 FM-1140 - 175 WWP (Fire Protection Systems)