

FORGED BRASS BALL VALVE

CAP & CHAIN

Two Piece Body • Full Port

Blowout Proof Stem • Chrome Plated Ball • PTFE Seats and Seals

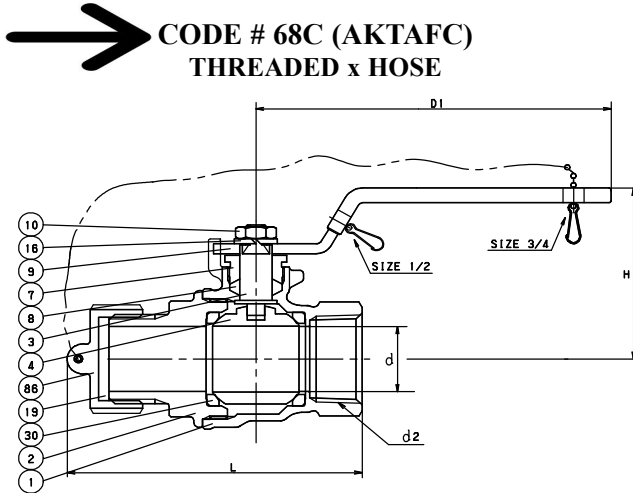

CODE # 68C (AKT AFC)
THREADED x HOSE

CODE # 69C (CT AFC)
SOLDER* x HOSE

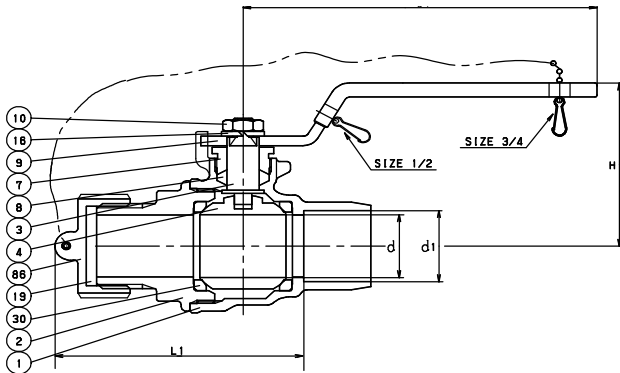

*REFERENCE VALVE INSTALLATION TIPS FOR SOUND SOLDER JOINTS (PAGE BV-70) OR SEE INSTALLATION SHEET PACKAGED WITH VALVE.

STANDARDS	
END TO END	KITZ
THREADED ENDS	ANSI B1.20.1/ANSI B2.4 3/4 11.5 NHR
SOLDER JOINT ENDS	ANSI B16.18/ANSI B2.4 3/4 11.5 NHR
WALL THICKNESS	KITZ
CONFORMS TO MSS-SP 110	

PRESSURE/TEMPERATURE	
150 PSI - SATURATED STEAM TO 366°F	
600 PSI - NON-SHOCK COLD WATER, OIL OR GAS	

NOTE: PRESSURE/TEMPERATURE CHART - PAGE BV-35

MATERIAL LIST		
NO.	NAME OF PART	SPECIFICATION
1	BODY	FORGED BRASS (B283, C37700)
2	BODY CAP (3/4")	BRASS ROD (B16) FORGED BRASS (B283, C37700)
3	STEM	(1) SPECIAL BRASS (KITZ, "K-METAL")
4	BALL	(2) FORGED BRASS (B283, C37700)
7	GLAND	BRASS ROD (B16)
8	GLAND PACKING	PTFE
9	HANDLE	(3) CARBON STEEL
10	HANDLE NUT	CARBON STEEL
16	SPRING WASHER	CARBON STEEL
19	GASKET	NBR
30	BALL SEATS	PTFE
86	CAP & CHAIN	(4) PP/BRASS

NOTES: (1) PROPRIETARY DEZINCIFICATION RESISTANT MATERIAL.
(2) CR. PLATING
(3) ELECTROPLATED ZINC WITH PLASTIC COVERING
(4) CAP IS NOT INTENDED TO RETAIN PRESSURE

DIMENSIONS • WEIGHTS • QUANTITIES										
	d2 SIZE	d	H	D1	L	L1	d1		APPROX. NET WT.	CARTON QTY
							Max.	Min.		
in.	1/2	0.59	1.65	3.23	2.93	2.46	.631	.627	52	96
mm.		14.0	41.9	82.0	74.4	62.5	16.0	15.9	23.6	
in.	3/4	0.79	2.01	3.94	3.3	2.79	.881	.877	50	60
mm.		20.1	51.1	100.1	83.8	70.9	22.4	22.3	22.7	

SPECIFICATION

Approved valve shall have two piece forged brass body, chrome plated ball, blowout proof stem, PTFE seats/seals, PP or brass cap & chain and full port design. Valves shall be pressure rated to 150 WSP/600 WOG and conform to MSS-SP 110.

KITZ Code No. 68C (AKT AFC) Threaded Ends
69C (CT AFC) Solder Ends